



Legato®

Carpet System By MILLIKEN®

Installation Instructions

Tools and materials needed

- Boxes of Legato carpet panels
- Transition strips and materials needed to install
- Self-retracting utility knife and extra blades (approximately 1 per box purchased)
- Protective work glove
- Straightedge at least 2' long
- Black felt tip marker
- Chalk line
- Measuring tape
- Broom and dustpan or vacuum
- Damp mop

Additional items that you may need, depending on your specific room situation or personal preference.

- Dust mask
- Knee pads
- Suitable material to fill holes or cracks
- Tools to remove tack strips and moulding
- Level to check slope of the floor
- Capture® Dry Carpet Cleaner

LEGATO IS NOT RECOMMENDED FOR USE AS AREA RUGS

PREPARING YOUR LEGATO PANELS:

- Your Legato carpet may have a new carpet smell when you first purchase it. Be sure to acclimate it to your surroundings for at least 24 hours. The odor will dissipate over time.

STEP ONE: Preparing the Subfloor

- Contact your waste management company or sanitation department prior to beginning your Legato installation to find out how to properly dispose of old flooring, carpet and pad.
- You can install Legato carpet panels directly over concrete, vinyl, hardwood, laminates, plywood or any flooring that is solid, firmly attached, smooth, dry, level and dust free. It is important that you install Legato over a clean floor. First sweep or vacuum your floor and then mop room with a damp mop to remove any remaining dust.
- It is always easier to work in a room that's empty of furniture, but because Legato carpet panels require no waiting after installation, you can move the furniture to one side of the room, install the panels, and then move the furniture back to finish the room.
- Remove any quarter-round moulding or tack strips. Removing the base moulding is optional. Installed properly, this product will be flush to the walls, and the quarter round can be re-installed at your discretion.

- Always remove old carpet and padding. You can install Legato over the old carpet adhesive as long as any adhesive ridges are no higher than 1/32" high.
- Fill any cracks or holes larger than 1/8" in the subfloor.
- Floors should be flat and level. Should you have any questions in this regard, please visit: www.legatocarpet.com or call 1-866-2-LEGATO.

Notes:

- Legato panels will install best if stored between 60° and 90°F for 24 hours prior to installation.
- If you experience continual dampness of your concrete floor, you should contact a professional before installing any flooring product.
- Legato carpet panels are not recommended for do-it-yourself installation on stairs.

STEP TWO: Installing your Legato Floor

- Begin by planning and laying out your room. Follow the Wall A and B layout steps shown in these instructions.
- Your Legato carpet panels are equipped with TractionBack®, a revolutionary patent pending installation system. TractionBack® does not require the use of additional adhesives.
- If you have access to the Internet, please visit www.legatocarpet.com and use the layout calculator to determine the starting point for your Legato installation.

Wall A Layout

Identify Wall A (See Fig 1, Wall A). This is the longest, straightest wall that does not have a door or hallway.

- Begin by measuring for a reference line on the floor. At one end of Wall A (See Fig 1, Wall A), measure out 12" from the wall and mark the floor. This will be Point 1. Do this at the other end of Wall A and mark the floor. This will be Point 2 (See Fig 1). Next, snap a chalk line between these two points. This chalk line marks the starting point for the flat side of your carpet panel installation.
- Now, move to the end of the reference line that is closest to a doorway and measure out 12" from that wall (Wall B). Make a mark on the floor. This is your starting point.
- Lay your first panel (for the remainder of these instructions, this panel will be known as **Panel 1**) so the corner touches the start point and the flat side touches the reference line (See Fig 2).

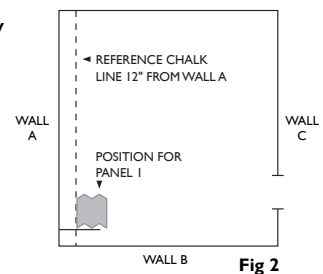
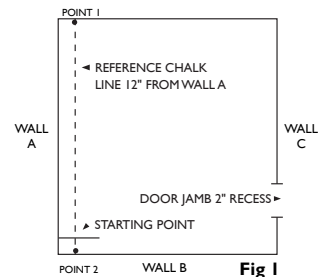

Important: Make sure the arrows on the back of all the panels point in the same direction for the entire installation (See Fig 3).



- **Important:** Avoid trapping yarns between the panels (See Fig 4). To prevent this, brush the yarns up with your hand to ensure they haven't fallen over the side of the panel.

However, if some yarns do become trapped, simply use a thin, dull, blunt instrument like a butter knife and run it between the panels to lift the yarns out of the seam.

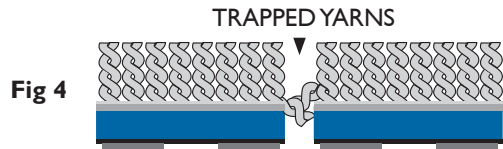

- **Important:** Install panels as snugly as possible without pushing them together so hard that they create a crown (See Fig 5). This will ensure that the walls and transitions can lock the panels in place.



- **Important:** When installing a carpet panel, hold the carpet panel by the two flat sides. Carefully place the wave edge against the wave edge of the last panel and pull together firmly for a secure, flush fit and then drop into place.

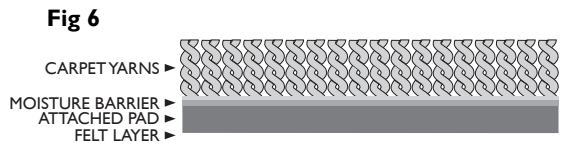

Now, feel around the moisture barrier (See Fig 6) at corner points where panels meet to make sure your alignment is accurate. If not, pull up the panel and replace until fit is correct.

- Install full panels along your reference chalk line until a full panel will no longer fit (See Fig 7).
- Measure the leftover gap. If it is 6" or more, you can proceed to the next step, "Wall B Layout," without making any adjustments.
- If the gap is less than 6", go back to Panel I and move it closer to Wall B to allow for the necessary 6" gap on the opposite wall (See Fig 7). For example, if you only have 2" left over, you will need to move Panel I 4" closer to Wall B. This will increase the gap to 6" on the opposite wall.

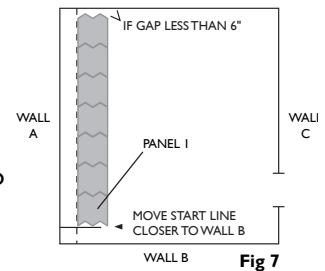

Wall B Layout

- Starting with Panel I, install a row of panels along Wall B until a full panel will no longer fit (See Fig 8). Make sure you keep the panels snug to each other.
- Measure the leftover gap. If it is 6" or more, you can skip the next step without making any adjustments.

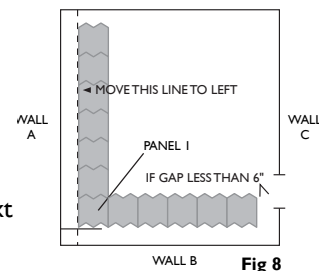

- If the leftover gap is less than 6", you will need to remove all panels and move the chalk reference line closer to Wall A. For example, if on Wall C your gap is 2", move the chalk line 4" closer to Wall A and the gap will increase to 6".

- See Figure 9 and apply panels in the sequence shown, again, checking each corner where panels meet to make sure they are perfectly aligned. Now install all of the full pieces of Legato carpet panels.

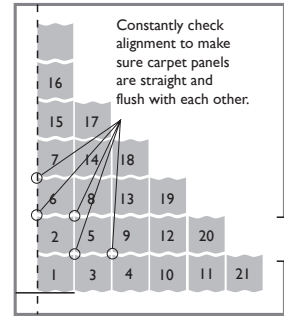

Fig 9

STEP THREE:

Cutting the Remaining Panels

Safety Notes:

Always wear a protective glove on the hand that is not holding the self-retracting utility knife for protection. Make sure that as you cut, you keep other parts of your body away from the cutting path.

Cutting your Legato panels to fit against walls

Tips:

- Cutting to fit against walls is the identical process for the wave edge of the carpet panel or the flat edge of the carpet panel.
- Arrows referred to are on the back of the panels.
- When marking your panel for cuts, it is best to use a fine felt tip pen or ball point pen.
- Panels you have cut should ALWAYS be positioned with the “cut side” against a wall.
- Measure twice, cut once!

Step 1: Place panel to be cut (B) against the last full panel (A), making sure that the arrows on the back are going in the same direction as the entire installation. Flip panel B face down on top of the last full panel as shown in step 1.

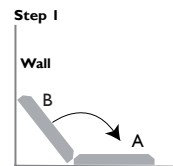

Step 2: With a locking tape measure, measure to the base board (or under the baseboard if the panel will be sliding under) to the last full panel at both **CORNERS** of the panel. Transfer the two measurements to the back of the upside down panel as shown in step 2.

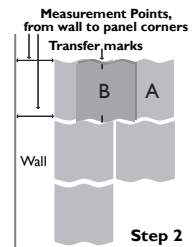

Step 3: Connect the measurements on panel B with a metal straight edge and cut. (Blades tend to last longer with smoother cuts if you cut through the felt, moisture barrier all in one pass). The cut piece closest to the wall is the one you will use (B). Save the other piece for possible use on the opposite wall. Make sure that there is a directional arrow on both pieces. If not, draw one with your felt tip marker.

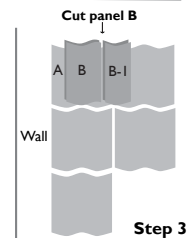

Step 4: Flip the cut panel (B) face up, making sure that the arrows are pointing in the same direction with the rest of the installation. Brush up any trapped yarns and place the panel snug to the last full panel (A) and to (or under) the baseboard.

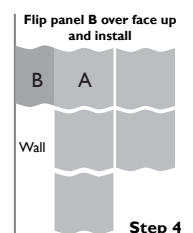

Using cut pieces on the opposite wall

Step 1: Take the unused cut panel from step 3 labeled B-I and position against the opposite wall of your installation, making sure that the arrows are pointing in the same direction with the rest of the installation.

Step 2: If the unused panel is larger than the space you need to fill, follow the same steps for “Cutting your Legato panels to fit against walls”.

Step 3: If the panel is smaller than the space you need to fill it cannot be used. Select a full panel of Legato and follow the same steps for “Cutting your Legato panels to fit against walls”.

Important: Where there are no walls to cut into (i.e., doors, adjacent rooms or hallways) you will need to install transitions. Do not install any cut pieces into these areas until transition strips are installed. Information on different transition methods is supplied in STEP 4, “Finishing Touches” section.

Cutting around irregular shapes or into corners

To cut to fit around custom mouldings, doorjamb, rock fire places and other irregular shapes or into corners, first use a piece of cardboard or stiff paper and make a template of the cut. You can then transfer the template to the carpet panel for cutting.

STEP FOUR: Finishing Touches

Transitions are used anywhere there is no wall against the Legato carpet panel. They serve three basic purposes:

1. Provide a short “wall” to hold the carpet panel in place.
 2. Protect the edges of the carpet panel.
 3. Provide a smooth transition from one flooring type to another that will eliminate any trip hazard and give the floor a finishing touch.
- Any transition piece that will butt up against your carpet panel should be at least 3/8" thick.
 - Transitions should be screwed or nailed to the subfloor whenever possible. If you can't nail or screw down the transition, construction adhesive for subfloors can sometimes be used as an alternative. Transitions come in many different materials, shapes and sizes and are readily available where you bought your Legato carpet panels. The most typical materials are wood, plastic or metal. Some of the more common shapes and their typical uses are listed below.

A. **Reducer** – Used to transition between two floorings of different thicknesses (example: Legato to a vinyl floor).

A

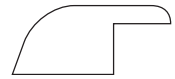

B. **T Moulding** – Used to transition between two floorings of similar heights (example: Legato to hardwood floors).

B

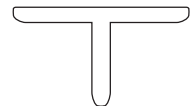

C. **Quarter Round** – Used to finish trim over flooring where it meets the baseboard.

C



D. **Threshold** – Typically used at doors to transition between two floorings of different thicknesses. It can also be used in ways similar to a reducer (Example: Legato to concrete).

D



E. **Carpet Reducer** – Commonly used to transition wall-to-wall carpet to vinyl floors. The carpet is pushed in over the “tacks” and then the top tab is bent down. These can be modified to work with Legato carpet panels by hammering the “tacks” down flush before installation. Carpet reducers are sometimes available without “tacks.”



Carpet Care and Maintenance

- Once you have completed your installation, you may step back and still see the hint of some seams. You should first check to make sure there are no trapped yarns, then vacuum the floor well and they’ll begin to disappear. After that, normal foot traffic will make the carpet yarns blend together.

Reminder: As mentioned earlier, if you find trapped yarns between the panels (See Fig 4), you can use a thin, dull, blunt instrument like a butter knife and run it between the panels to lift the yarns out of the seam.

- One of the biggest advantages to your new Legato carpet system floor is that you can deal with stains, wear and “life’s little surprises” that can ruin a regular carpet. Here are some tips on how to handle these surprises.
- **Vacuum your carpet once per week**, especially in traffic lanes, to remove dirt and soil and to keep carpet pile upright. Use an upright, top fill with a beater bar brush for best results. Change vacuum bags regularly to improve the vacuum’s ability to remove soil.
- For the best cleaning results Milliken recommends using Capture® Dry Carpet Cleaner to maintain the beauty of your new carpet.
- Do not use cleaners that contain mineral based solvents on your Legato panels. These types of cleaners will damage the panels.

Replacing a carpet panel:

- If necessary, you can also take up the panel and simply replace it with another one. You can either use panels that may be left over from the installation, or you can exchange the highly visible Legato carpet panel with a less visible one (for example, under the sofa).

Remember: Store extra panels for future use in clean, dry area.



Copyright Milliken & Company (2002) – The designs displayed herein represent Milliken & Company’s original work and are protected by copyright. Unauthorized use of the designs may be subject to criminal and/or civil penalties pursuant to Title 17 U.S.C. Section 501 et seq. of the Copyright Act.

Summary - Legato Warranties

Legato Carpet System Warranty

Proper installation plays a key role in the performance of Legato Carpet System. Installation defects are not covered by our warranty and are the responsibility of the installer. Legato carpet should be installed according to the Legato Installation Instructions. If the instructions are followed, Milliken & Company guarantees the following warranties:

10 Year Limited Abrasive Wear Guarantee

Milliken & Company guarantees that your new Legato carpet will not wear more than 10 percent by abrasion within 10 years of installation. That does not include damage caused by improper installation, pets, cuts, pilling, shedding, matting, crushing, burns, and improper maintenance or cleaning methods.

10 Year MilliGuard® Soil and Stain Warranty

Milliken warrants for a full 10 years after installation, that the surface pile of Legato carpet, treated with MilliGuard® will resist stains. Milliken will repair, or replace, if repair cannot be made, any area of the carpet that does not perform as warranted. While this carpet provides advanced resistance to stains, no carpet is stain proof. Stains by urine and feces, drain cleaners, plant food, acne medication, bleaches, vomit, food with strongly colored material and dispensed dyes are excluded from this warranty. This warranty is non-transferable from the original purchaser and only to carpet used for residential, indoor purposes at owner occupied locations

10-Year Limited Manufacturing Defects Warranty

Milliken & Company warrants that your Milliken Legato residential carpet will be free from manufacturing defects upon original installation. Prompt recording of claims for defects upon original installation is required. Milliken also extends a 10 Year Guarantee against manufacturing defects from the carpets original installation. Milliken will repair or replace your defective Legato carpet with a product of the same quality and/or color or a product of comparable quality if the original product is not available. Such conditions as pulled loops, snags, shedding, pilling, fuzzing, matting and/or crushing are not considered manufacturing defects. Proper maintenance of your carpet will minimize or eliminate the preceding conditions.

10 Year No Mat and No Crush Warranty (Texture Retention)

Milliken & Company guarantees that your Legato carpet will not mat or crush from foot traffic as a result of the yarn tuft unraveling or losing twist provided your carpet is properly maintained.

7 Year Scotchgard Limited Stain Release Warranty

Scotchgard™ Protection and Stain Release Seven Year Limited Residential Warranty - 3M warrants carpets that are mill treated with Scotchgard Protection and Stain Release to resist permanent staining from most common food and beverage stains for a period of seven years from the date of original purchase. This warranty is offered only to the original carpet purchaser and is not transferable.

5 Year Delamination of Backing Warranty

Milliken warrants the secondary backing of Legato carpet will not delaminate within five years after installation, provided it is installed and maintained in accordance with current and published Milliken procedures.

• In order to obtain service under this warranty, please contact the store where you purchased the Legato carpet and describe the problem as fully as possible. If you are unable to contact the store, or do not receive satisfaction, write to us at:

Milliken Residential

P.O. Box 2956

La Grange, GA 30241

Or call toll free 1-866-2-LEGATO

www.legatocarpet.com

